

# **TRAFFIC REGULATION ORDER (TRO) CONSULTATION**

**CRW2405RC – Byron Close, Crawley~**

**29/1/25 – 19/2/25**

## **Contents**

Notice	Page 2
Statement of Reasons	Page 3
Draft Order	Page 4
Plan “c_crawleytq2837sen” - existing restrictions	Page 5
Plan “c_crawleytq2837sen” - proposals	Page 6

**WEST SUSSEX COUNTY COUNCIL**  
**((CRAWLEY BOROUGH) (PARKING PLACES AND TRAFFIC REGULATION)**  
**(CONSOLIDATION) ORDER 2010)**  
**(BYRON CLOSE AMENDMENT) ORDER 202\***

**NOTICE** is hereby given that West Sussex County Council propose to make a permanent Order under the provisions of the Road Traffic Regulation Act 1984, the effect of which will be to extend the length of prohibition of waiting at all times (double yellow lines) on the southern side of Byron Close, east of St Marys Drive, eastwards by a distance of 40metres.

Full details of the proposals in this Notice can be viewed on our website [www.westsussex.gov.uk/tro](http://www.westsussex.gov.uk/tro). The website includes a response form for comments or objections.

Paper copies of documents will not be available to view in council offices or libraries. People without access to a computer who wish to view details of the scheme should telephone the West Sussex County Council Contact Centre on 01243 642105 to receive the documents by post.

Any objections or comments about the proposal must be received by 19 February 2025. These may be sent via the response form on the website, in writing to: TRO Team, West Sussex County Council, The Grange, Tower Street, Chichester, PO19 1RH; or by e-mail to: [tro.consultation@westsussex.gov.uk](mailto:tro.consultation@westsussex.gov.uk). All correspondence should be addressed to the undersigned, quoting reference no. TRO/CRW2405/RC. Only correspondence including a full name and address will be considered.

Dated this 29<sup>th</sup> January 2025  
Director of Law & Assurance  
County Hall  
Chichester

**WEST SUSSEX COUNTY COUNCIL**  
**((CRAWLEY BOROUGH) (PARKING PLACES AND TRAFFIC REGULATION)**  
**(CONSOLIDATION) ORDER 2010)**  
**(BYRON CLOSE AMENDMENT) ORDER 202\***

**STATEMENT OF REASONS FOR PROPOSING TO MAKE THE ORDER**

The County Council in exercise of their powers under the Road Traffic Regulation Act 1984, propose to introduce a permanent Order the effect of which will be to extend the length of prohibition of waiting at all times (double yellow lines) on the southern side of Byron Close, east of St Marys Drive, eastwards by a distance of 40metres.

Byron Close is a residential cul-de-sac in close proximity to Three Bridges railway station and on the periphery of a Controlled Parking Zone. This creates a high demand for on-street parking with railway commuters and residents from the CPZ vying for spaces with residents. Current on-street parking practice causes localised obstruction and access difficulties and, on occasion Sussex Police have been called to deal with obstructive parking. The Council received a request to address this issue.

The road has a narrow width and is an access road to residential properties. Vehicles are frequently parking on the footways and without consideration for residential access. This can obstruct forward visibility for other drivers and pedestrians.

To alleviate the problem, it is proposed to introduce a TRO to prohibit parking by extending a length of double yellow lines on the southern side of Byron Close. The extended double yellow lines aim to better manage parking and deter obstructive parking practices. This will ensure that all road users will have better forward visibility.

This Order is proposed for avoiding danger to persons or other traffic using the road or any other road or for preventing the likelihood of any such danger arising and for facilitating the passage on the road or any other road of any class of traffic (including pedestrians) and for preserving or improving the amenity of the area through which the road runs.

Plan No. TQ2837SEN

shows the lengths of road, which are the subject of the proposed Order.

Director of Law & Assurance  
County Hall  
Chichester

Dated January 2025

**WEST SUSSEX COUNTY COUNCIL**  
**((CRAWLEY BOROUGH) (PARKING PLACES AND TRAFFIC REGULATION)**  
**(CONSOLIDATION) ORDER 2010)**  
**(BYRON CLOSE AMENDMENT) ORDER 202\***

West Sussex County Council in exercise of their powers under Sections 1 (1) 2 (1) and (2), 4 (2), 45, 46, 49 and 53 and Part IV of Schedule 9 of the Road Traffic Regulation Act 1984 "the Act" as amended and of all other enabling powers and after consultation with the chief officer of police in accordance with Part III of Schedule 9 to the Act hereby make the following Order:-

1. This Order shall come into operation on the x day of x 2025 and may be cited as "West Sussex County Council ((Crawley Borough) (Parking Places and Traffic Regulation) (Consolidation) Order 2010) (Byron Close Amendment) Order 202\*."
2. The "West Sussex County Council (Crawley Borough) (Parking Places and Traffic Regulation) (Consolidation) Order 2010" is hereby amended by the deletion from it of the plan specified in the First Schedule to this Order and the substitution into it of the plan attached in the Second Schedule to this Order.

**FIRST SCHEDULE**  
**Plan to be deleted**

TQ2837SEN (Sheet Issue No. 7)

**SECOND SCHEDULE**  
**Plan to be substituted**  
**(as attached)**

TQ2837SEN (Sheet Issue No. 8)

**For and on behalf of WEST SUSSEX COUNTY COUNCIL**

*Authorised Signatory:*

*NAME:*

*DATE MADE:*

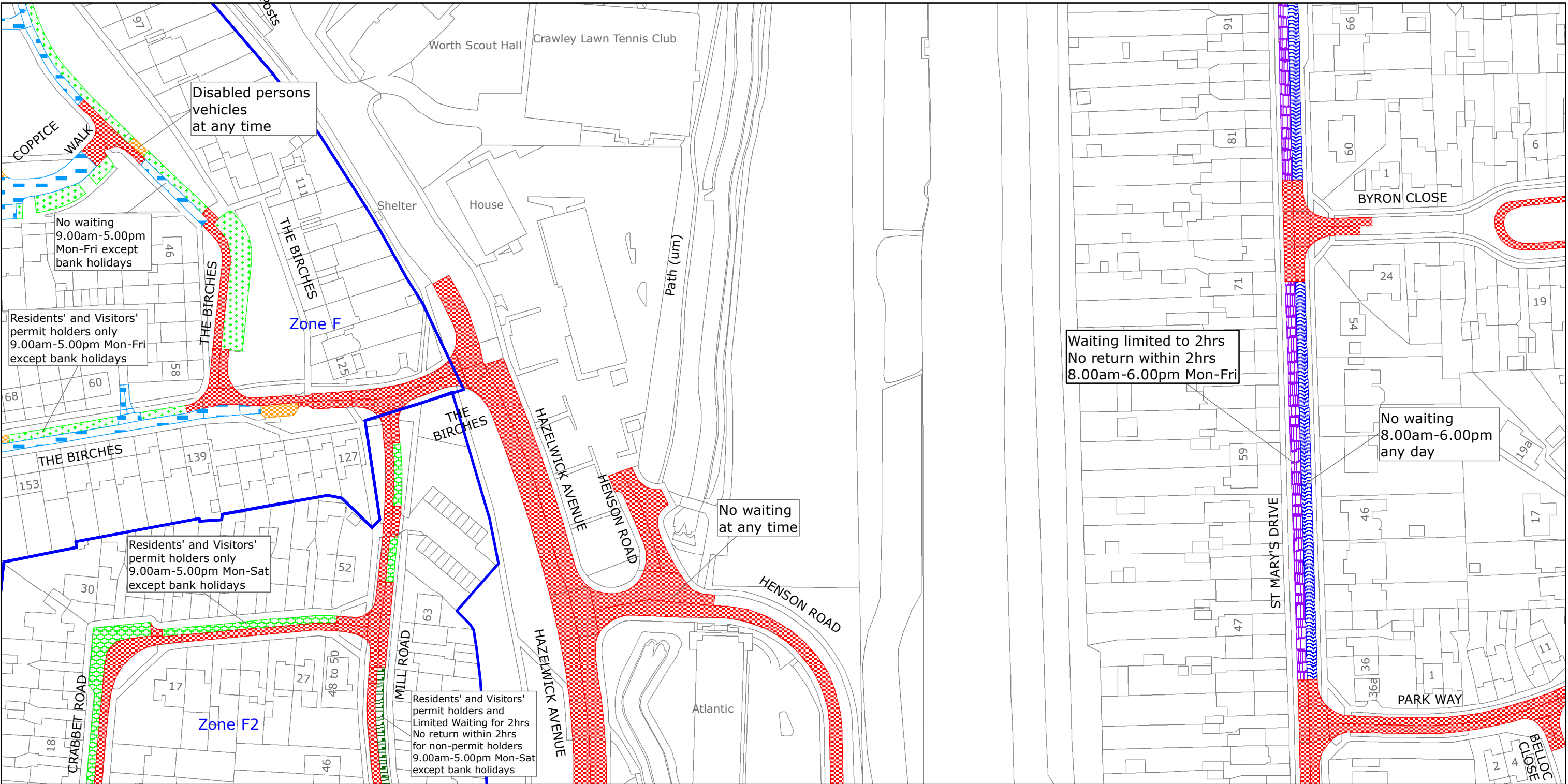

West Sussex County Council  
Highways & Transport  
The Grange  
Tower Street  
Chichester  
West Sussex  
PO19 1RH

CRAWLEY BOROUGH: POUND HILL NORTH & FORGE WOOD  
AND THREE BRIDGES WARDS

WAITING RESTRICTIONS

Reproduced from or based upon 2021 Ordnance Survey mapping with permission of the Controller of HMSO (c) Crown Copyright reserved.  
Unauthorised reproduction infringes Crown copyright and may lead to prosecution or civil proceedings West Sussex County Council Licence No. 100018485

TILE REF NO:  
TQ2837SEN

SHEET ISSUE NO 7  
SHEET ACTIVE FROM - 16.08.2021



SCALE:  
1:1250  
at A3 size



PAGE 2 OF 2: PROPOSED CHANGES TO RESTRICTIONS (CIRCLED)

