

TRAFFIC REGULATION ORDER (TRO) CONSULTATION

ARN-8010-MM – Bognor Regis: The Esplanade

6/6/24 – 27/6/24

Contents

Notice	Page 2
Statement of Reasons	Page 3
Draft Parking Order	Page 5
Draft Speed Order	Page 6
Plans – existing & proposed	Pages 7-11

West Sussex County Council
((Arun District) (Parking Places & Traffic Regulation) (Consolidation) Order
2010)
(Bognor Regis: The Esplanade Amendment) Order 2024

And

West Sussex County Council (Bognor Regis: The Esplanade) (20 MPH Speed
Limit) Order 2024

And

Bognor Regis: The Esplanade Traffic Calming Features

NOTICE is hereby given that West Sussex County Council proposes to make two permanent Traffic regulation Orders under the provisions of the Road Traffic Regulation Act 1984.

The effect of the first Order will be to amend the layout of the parking bays on The Esplanade in Bognor Regis between its junctions with Lennox Street and Clarence Road.

The second Order introduces a 20 MPH speed limit on The Esplanade from its junction with Lennox Street eastwards to its junction with Clarence Road.

It is also proposed to install three raised traffic calming features on The Esplanade. Features would be installed at the location of both current puffin crossings between Lennox Street and Clarence Road, with a further feature approximately 50m east of its junction with Lennox Street. These features will be constructed in black macadam and constructed 6m in width and 65mm in height.

Full details of the proposals in this notice can be viewed on the Traffic Regulation Order page of the [West Sussex County Council website](#). The website includes a response form for any comments or objections.

People without access to a computer who wish to view details of the scheme should telephone the West Sussex County Council Contact Centre on 01243 642105 to receive the documents by post.

Any comments or objections about the proposal must be received before 27 June 2024. These may be submitted via the response form on the website mentioned above, by e-mail to tro.consultation@westsussex.gov.uk or in writing to TRO Team, West Sussex County Council, The Grange, Tower Street, Chichester, PO19 1RH. For legal reasons, only correspondence including a full name and address will be considered. Please quote reference ARN8010-MM in all correspondence.

Dated this 6th day of June 2024.
Director of Law & Assurance, County Hall, Chichester.

West Sussex County Council
((Arun District) (Parking Places & Traffic Regulation) (Consolidation) Order
2010)
(Bognor Regis: The Esplanade Amendment) Order 2024

And

(Bognor Regis: The Esplanade) (20 MPH Speed Limit) Order 2024

And

Bognor Regis: The Esplanade Traffic Calming Features

Statement of Reasons for Proposing to Make the Order

West Sussex County Council proposes to make two permanent Traffic Regulation Orders, the first of which will amend the layout of the parking bays on The Esplanade in Bognor Regis between its junctions with Lennox Street and Clarence Road.

The second Order introduces a 20 MPH speed limit on The Esplanade from its junction with Lennox Street eastwards to a point 10m east of its junction with Clarence Road.

It is also proposed to install three raised traffic calming features on The Esplanade. Features would be installed at the location of both current puffin crossings between Lennox Street and Clarence Road, with a further feature approximately 50m east of its junction with Lennox Street. These features will be constructed in black macadam and constructed 6m in width and 65mm in height.

West Sussex County Council and Arun District Council have formed a joint project to deliver public realm improvements at various locations in Bognor Regis, including The Esplanade. The project aims to improve pedestrian access between The Esplanade and the seafront by providing improved crossing points and a walkway between the parking areas and the sea wall as well as regenerating the seafront area to become a vibrant visitor destination.

The proposed changes to the parking bays are needed to accommodate alterations to the kerb-lines required by the installation of the new traffic calming and new walkway features, which improve access to parking spaces next to the sea wall. To improve safety a 20 MPH speed limit is proposed, with traffic calming features to encourage compliance with the new lower speed limit.

More details of the aims of the scheme, including artists impressions of the finished project can be accessed via the following link:

[Bognor Regis Esplanade Public Realm Improvements | Your Voice West Sussex](#)

The new orders and traffic calming features are proposed to avoid danger to persons or other traffic using the affected lengths of road and to improve the amenities of the area through which the road runs.

The attached drawing, no. SZ9398NEN shows the amended parking restrictions, drawing no. ARN8010 shows the length of proposed speed limit, and further drawings are attached showing the location of the proposed traffic calming features.

Director of Law & Assurance
8 May 2024
ARN8010-MM

WEST SUSSEX COUNTY COUNCIL
((ARUN DISTRICT) (PARKING PLACES & TRAFFIC REGULATION)
(CONSOLIDATION) ORDER 2010)

(BOGNOR REGIS: THE ESPLANADE AMENDMENT) ORDER 2024

West Sussex County Council in exercise of their powers under Sections 1 (a) 2 (1) and (2), 4 (2), 45. 46. 49 and 53 and Part IV of Schedule 9 of the Road Traffic Regulation Act 1984 ("the Act") as amended and of all other enabling powers and after consultation with the Chief Officer of Police in accordance with Part III of Schedule 9 to the Act hereby make the following Order:-

1. The Order shall come into operation on the ***** day of ***** 2024 and may be cited as "West Sussex County Council) ((Arun District) (Parking Places & Traffic Regulation) (Consolidation) Order 2010) (Bognor Regis: The Esplanade Amendment) Order 2024".
2. The "West Sussex County Council ((Arun District) (Parking Places & Traffic Regulation) (Consolidation) Order 2010" is hereby amended by the replacement of the plan specified in the First Schedule to this Order, with the plan specified in the Second Schedule, attached hereto.

FIRST SCHEDULE
Plans to be Replaced

SZ9398NEN (Issue Number 3)

SECOND SCHEDULE
Replacement Plans

SZ9398NEN (Issue Number 4)

For and on behalf of WEST SUSSEX COUNTY COUNCIL

Authorised Signatory:

NAME:

DATE MADE:

ARN8010-MM

WEST SUSSEX COUNTY COUNCIL
(BOGNOR REGIS: THE ESPLANADE) (20 MPH SPEED LIMIT) ORDER 2024

West Sussex County Council in exercise of their powers under Section 84 (1) a of the Road Traffic Regulation Act 1984 ("the Act"), and after consultation with the chief officer of police in accordance with Part III and Part IV of Schedule 9 to the Act hereby make the following Order:-

1. This Order shall come into operation on the ***** day of ***** and may be cited as "West Sussex County Council (Bognor Regis: The Esplanade) (20 MPH Speed Limit) Order 2024"
2. No person shall cause or permit any vehicle to proceed at a speed exceeding 20 miles per hour in the length of road specified in the Schedule to this Order.
3. Nothing in Paragraph 2 shall apply to a vehicle being used by naval, military or air force purposes while being driven by a person for the timebeing subject to the orders of a member of the armed forces of the Crown on an occasion when –
 - (a) the person driving the vehicle is a member of the special forces as defined by the Road Traffic Exemptions (Special Forces) (Variation and Amendment) Regulations 2011; and
 - (b) the vehicle is being driven-
 - (i) in response, or for practice in responding, to a national security emergency by a person who has been trained in driving vehicles at high speeds; or
 - (ii) for the purpose of training a person in driving vehicles at high speeds.

SCHEDULE
20 MPH Speed Limit

Road in Bognor Regis	Affected Length of Road
The Esplanade	From its junction with Lennox Street eastwards to a point 10 metres east of its junction with Clarence Road

For and on behalf of WEST SUSSEX COUNTY COUNCIL

Authorised Signatory:

NAME:

DATE MADE:

ARN8010-MM

PAGE 1 OF 2: EXISTING RESTRICTIONS ONLY

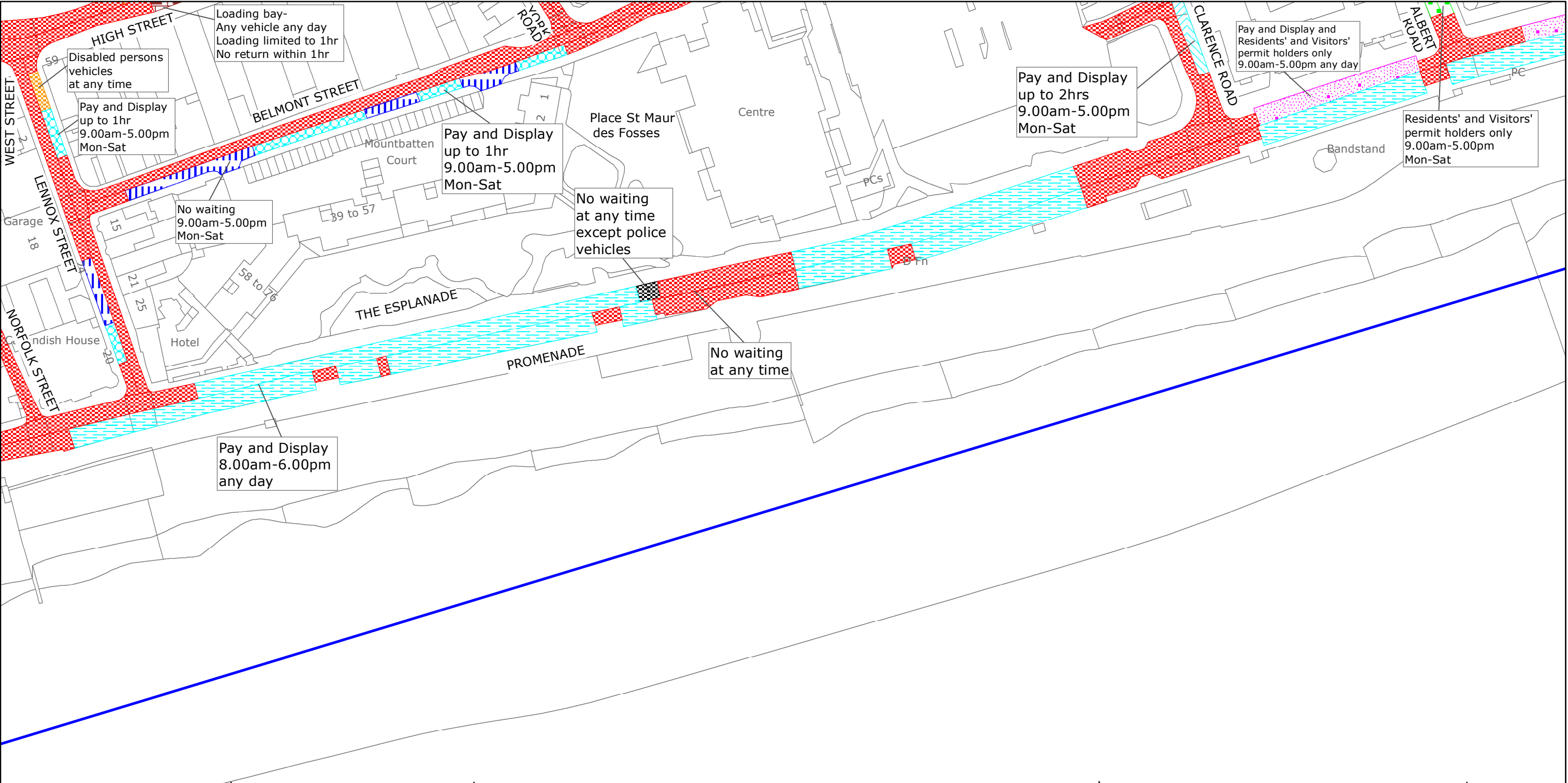

West Sussex County Council
Highways & Transport
The Grange
Tower Street
Chichester
West Sussex
PO19 1RH

ARUN DISTRICT: BOGNOR REGIS
WAITING RESTRICTIONS

Reproduced from or based upon 2018 Ordnance Survey mapping with permission of the Controller of HMSO (c) Crown Copyright reserved.
Unauthorised reproduction infringes Crown copyright and may lead to prosecution or civil proceedings West Sussex County Council Licence No. 100018485

TILE REF NO:
SZ9398NEN

SHEET ISSUE NO 3
SHEET ACTIVE FROM - 19/02/2018

N
SCALE:
1:1250
at A3 size

PAGE 2 OF 2: PROPOSED CHANGES TO RESTRICTIONS (CIRCLED)

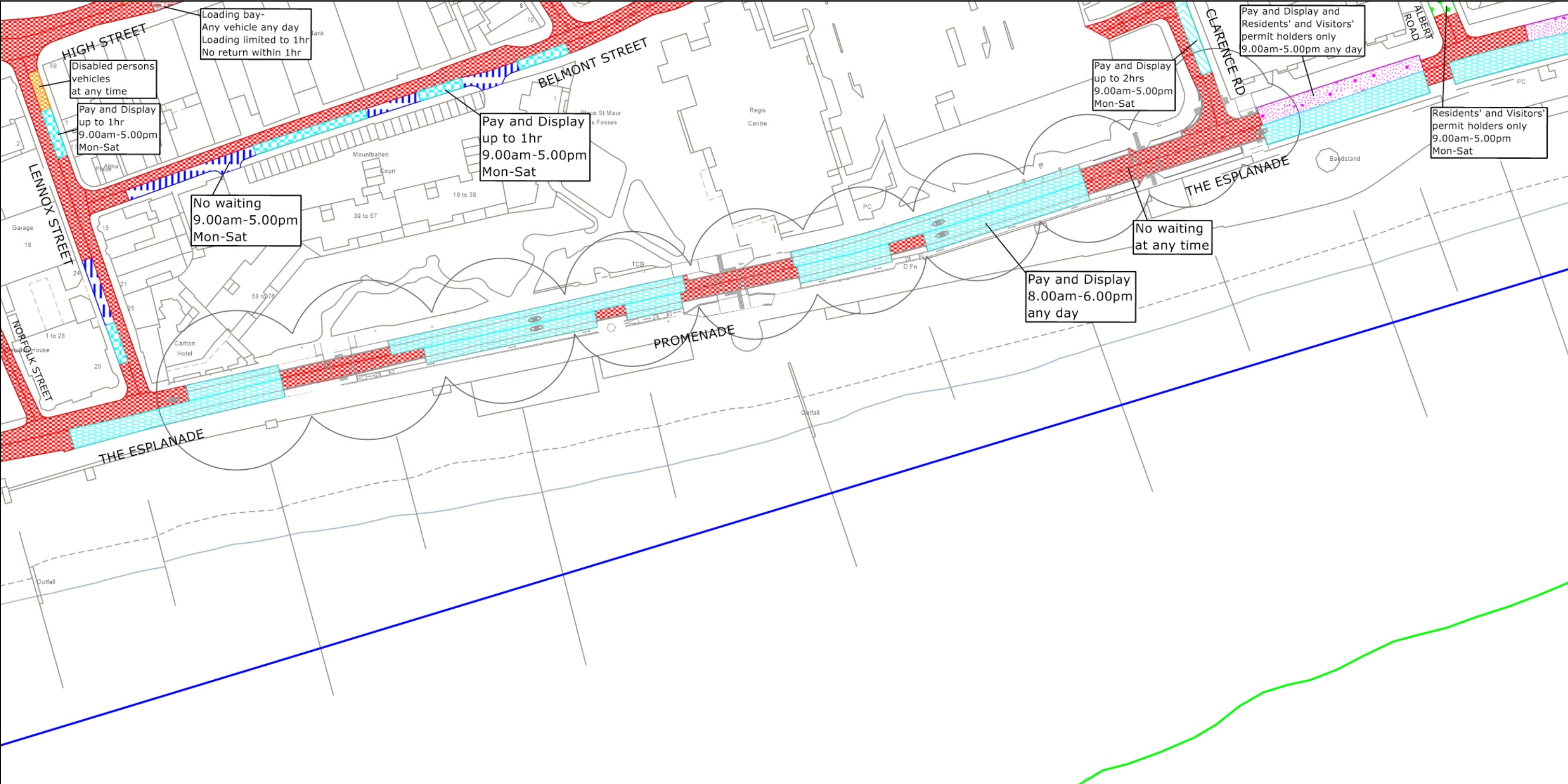

KEY

SPEED LIMITS

Proposed 20mph Speed Limit

Existing 30mph Speed Limit

The map displays a section of The Esplanade in Bognor Regis. A red hatched pattern covers a significant portion of The Esplanade, indicating a proposed 20mph speed limit. A pink dotted pattern is shown in some areas, indicating an existing 30mph speed limit. The map includes several street names: York Road, Belmont Street, Clarenc Road, and The Esplanade. Other labels include 'PROMENADE', 'LENNOX STREET', 'Bank', 'Mountbatten Court', 'Place St Maur des Fosses', 'Regis Centre', 'TCB', 'D Fn', 'PC', 'Council Offices', 'WRVS Kitchen', 'Berkeley Court', 'Eastlands', 'Shoreham', 'Cartref', 'Belmont Lodge', 'White House', 'The Arcade', 'Yok Rd Chambers', 'Bank', 'Alma Place', 'Carlton Hotel', '58 to 76', '19 to 38', '39 to 57', '14 to 18', '1 to 12', '2', '3', '4', '5', '6', '7', '8', '9', '10', '11', '12', '13', '14', '15', '16', '17', '18', '19a', '20', '21', '21A', '1 to 52', and 'Outfall'. The map also shows a blue line representing a water feature or path.

© Crown copyright and database rights 2024 OS AC0000849983. You are permitted to use this data solely to enable you to respond to, or interact with, the organisation that provided you with the data. You are not permitted to copy, sub-license, distribute or sell any of this data to third parties in any form.

west sussex county council

ARUN DISTRICT: BOGNOR REGIS - THE ESPLANADE

PROPOSED 20MPH SPEED LIMITS (19.04.2024_SR)

ARN8010

N

1:1000 at A3 size

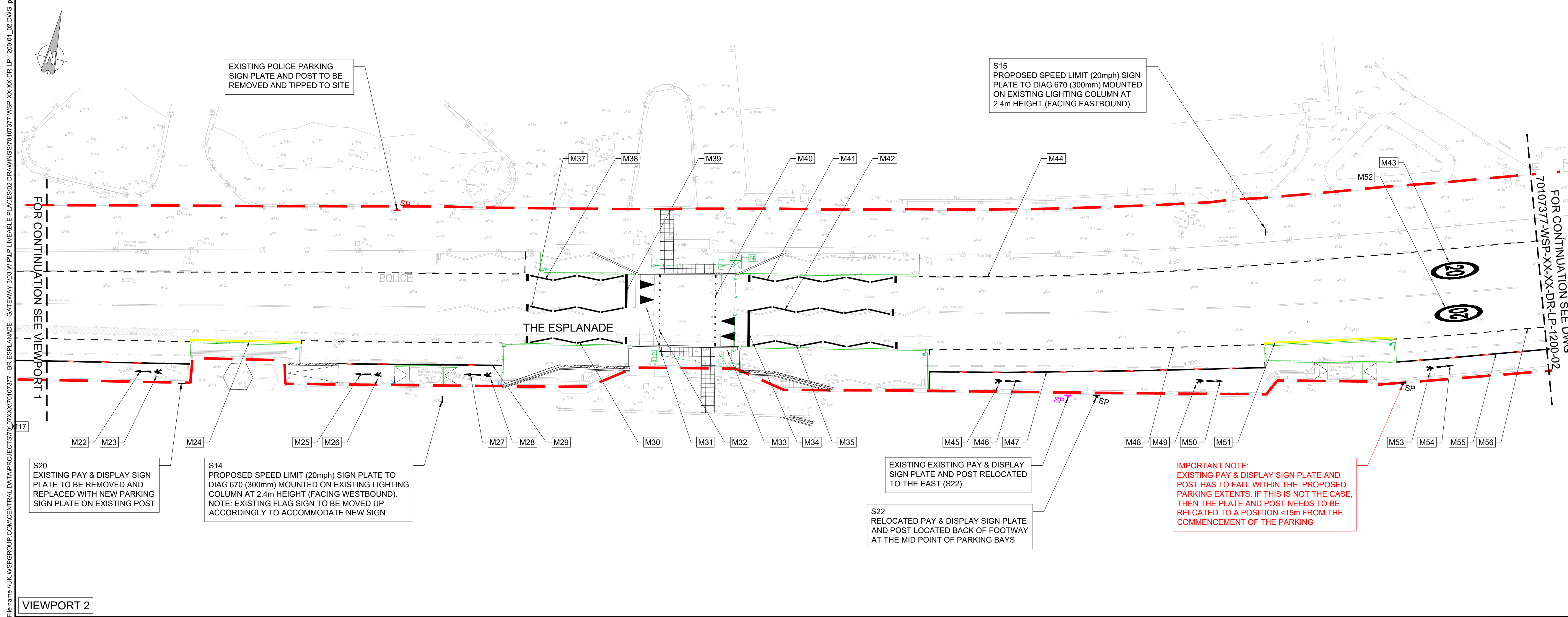
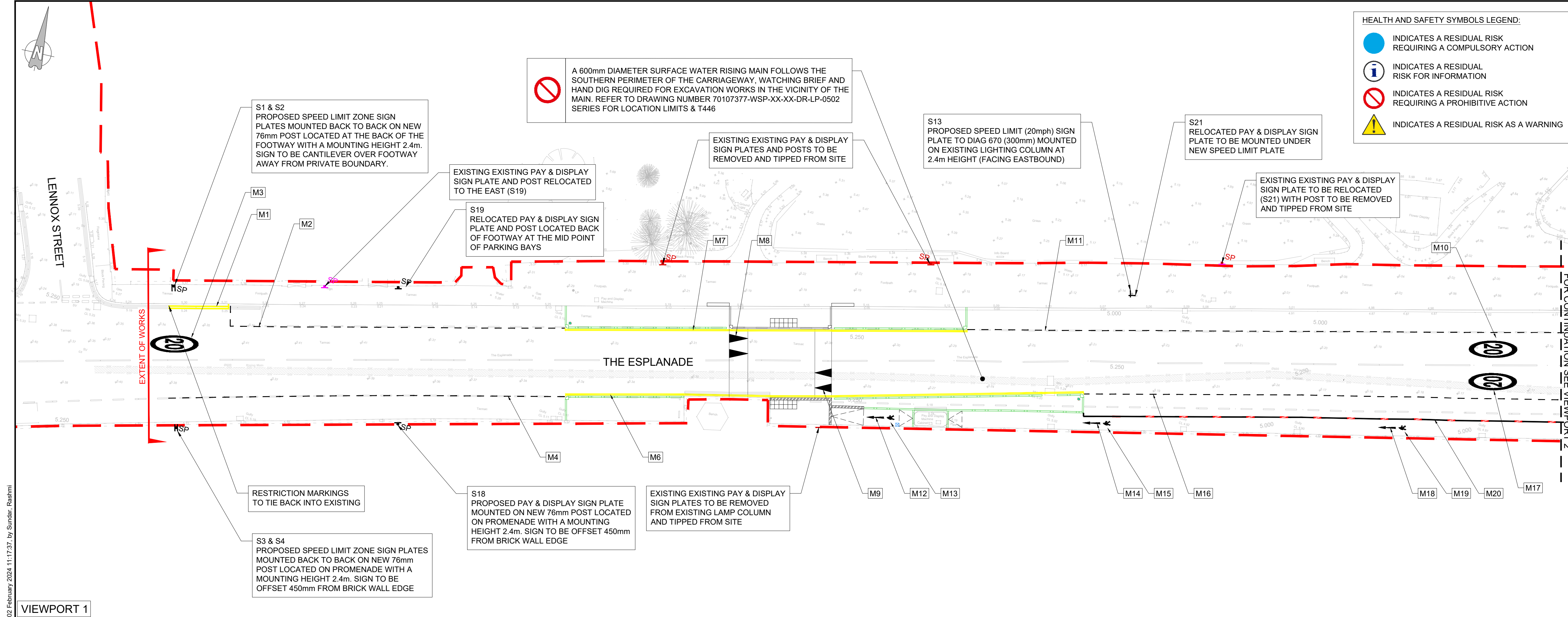

HEALTH AND SAFETY SYMBOLS LEGEND:

- INDICATES A RESIDUAL RISK REQUIRING A COMPULSORY ACTION
- INDICATES A RESIDUAL RISK FOR INFORMATION
- INDICATES A RESIDUAL RISK REQUIRING A PROHIBITIVE ACTION
- INDICATES A RESIDUAL RISK AS A WARNING

DO NOT SCALE

NOTES:

- ALL DIMENSIONS IN METRES UNLESS OTHERWISE STATED.
- THIS DRAWING SHOULD BE READ IN CONJUNCTION WITH ALL OTHER DETAIL DESIGN DRAWINGS AND DOCUMENTS.
- ALL WORK TO BE IN ACCORDANCE WITH THE DESIGN MANUAL FOR ROADS AND BRIDGES (DMRB) WHERE APPROPRIATE AND WEST SUSSEX COUNTY COUNCIL DESIGN HIGHWAY STANDARD DETAILS.
- HIGHWAY BOUNDARY HAS BEEN PROVIDED BY WSCC AND HAS BEEN ADJUSTED TO THE TOPOGRAPHICAL SURVEY FEATURES.
- TOPOGRAPHICAL SURVEY BASED ON DRG NO. 7009945-SUR-001 & 002 DATED NOVEMBER 2022 ORIGINATING FROM WSP SURVEYS.
- CONTRACTOR TO LOCATE ALL UTILITY AND DRAINAGE ASSETS LOCATIONS ALONG WITH THE PRE-CONSTRUCTION PACK AND CO-ORDINATE SAFE WORKING PROCEDURES PRIOR TO ANY EXCAVATION WORKS TAKE PLACE.
- THE CONTRACTOR SHALL VALIDATE THE ACCURACY OF THE TOPOGRAPHICAL SURVEY PRIOR TO ANY CONSTRUCTION WORKS BEING CARRIED OUT.
- FOR ROAD MARKING REQUIREMENTS, REFER TO THE ROAD MARKING SCHEDULE WITHIN THIS SERIES.
- FOR DETAILS OF PROPOSED TRAFFIC SIGNS, REFER TO SIGNING SCHEDULE WITHIN THIS SERIES FOR SIGN FACE ASSEMBLIES AND POST AND FOUNDATIONS DETAILS.
- ALL ROAD MARKINGS SHALL BE IN ACCORDANCE WITH THE TRAFFIC SIGNS REGULATIONS AND GENERAL DIRECTIONS 2016, CHAPTER 5 OF THE TRAFFIC SIGNS MANUAL AND SUBSEQUENT AMENDMENTS.
- ALL ROAD MARKINGS SHALL BE DEFAULT SIZE UNLESS OTHERWISE STATED, REFER TO ROAD MARKING SCHEDULE.
- ALL PROPOSED ROAD MARKINGS SHALL TIE NEATLY INTO EXISTING ROAD MARKINGS (WHERE NECESSARY).
- FOR ROAD MARKING REQUIREMENTS, REFER TO THE ROAD MARKING SCHEDULE WITHIN THIS SERIES.
- THE SKID RESISTANCE VALUE OF PERMANENT ROAD MARKINGS SHALL NOT BE LESS THAN 55 PSV.
- ALL ROAD MARKINGS ARE TO BE LAID WITH MMA 150MCD RETROREFLECTIVITY.
- DRAINAGE GAPS OF 150mm ARE TO BE PROVIDED AT INTERVALS OF APPROXIMATELY 10m ALONG THE LENGTH OF DIAG 1012.1
- THE EDGE OF PROPOSED / RELOCATED SIGN FACES SHALL BE SET BACK 600mm FROM EDGE OF CARRIAGEWAY WHERE REASONABLY PRACTICAL. ABSOLUTE MINIMUM SET BACK IS 400mm.
- FOR DETAILS OF EXISTING UTILITIES, REFER TO DRAWING NUMBER 70107377-WSP-XX-XX-DR-LP-0502-SERIES.

KEY:

- SP PROPOSED TRAFFIC SIGN PLATE AND POST (WHERE ANNOTATED ON THE DRAWING), REFER TO SIGN SCHEDULE FOR SIGN PLATE, POST, FOUNDATION AND ASSEMBLY DETAILS.
- SP EXISTING TRAFFIC SIGN PLATE AND POST (WHERE ANNOTATED ON THE DRAWING) TO BE REMOVED AND TIPPED FROM SITE
- SP EXISTING TRAFFIC SIGN PLATE AND POST (WHERE ANNOTATED ON THE DRAWING) TO BE RELOCATED
- PROPOSED SIGNAL POLES WITH ASSOCIATED NAL SOCKETS AND DRAWPIITS - CURRENTLY SHOWN INDICATIVELY - FULL DESIGN CARRIED OUT BY TELENT AND INSTALLATION WORKS ARE TO BE CO-ORDINATED AND BASED ON TELENT DESIGN. REFER TO TELENT DESIGN SUBMISSION FOR FULL PACKAGE OF DRAWINGS AND SPECIFICATIONS

THE CONTRACTOR SHALL NOTIFY THE PROJECT MANAGER OF ANY AMBIGUITIES OR INCONSISTENCIES WITHIN THE DOCUMENTS (WHICH ARE PART OF THIS CONTRACT) AS SOON AS THE CONTRACTOR BECOMES AWARE

DRAWING DESIGN PACKAGE SHOWS THE PERMANENT WORK ELEMENTS / AREAS ONLY. TEMPORARY WORKING AREAS, ACCESS ROUTES, ETC., ARE TO BE DETERMINED BY CONTRACTOR. THE CONTRACTOR SHALL NOTE THE PRESENCE OF EXISTING UTILITIES AS SHOWN ON DRAWING NUMBER 70107377-WSP-XX-XX-DR-LP-502-SERIES AND CONSIDER THE UTILITY INTERFACE AND ADDITIONAL SITE CLEARANCE NECESSARY FOR ANY TEMPORARY WORKS REQUIRED.

IMPORTANT NOTE:
NO EXISTING ROAD MARKINGS TO BE REMOVED AS THE EXISTING CARRIAGEWAY IS TO BE RESURFACED AS PART OF THE SCHEME WORKS.
SURFACING WORKS TO BE COORDINATED BY WSCC PRIOR TO ROAD MARKING INSTALLATION

CO2	15/01/2024	RS	NORTHERN RAINWATER GARDEN AT MAIN CROSSING REDUCED, SOUTHERN KERB LINE AT MAIN CROSSING EXTENDED OUT AND ROUNDELS RELOCATED BASED ON WSCC INSTRUCTION	PW	RA
CO1	07/12/2023	RS	ISSUED FOR CONSTRUCTION	RA	SG
PO2	29/11/2023	RS	IMPRINT COLOUR CHANGE AND REMOVAL AT UNCONTROLLED CROSSING POINTS + REMOVAL OF BLUE BACKING ON PFD SYMBOLS + UNCONTROLLED CROSSING POINT WIDENED	RA	SG
PO1	16/10/2023	GW	FIRST ISSUE	RA	SG
REV	DATE	BY	DESCRIPTION	CHK	APP

DRAWING STATUS: S5 - FOR CONSTRUCTION

wsp

2 London Square, Cross Lanes, Guildford, GU1 1UN, UK
T+ 44 (0) 1483 528 400
wsp.com

CLIENT:
West Sussex County Council
Highways, Transport and Planning
County Hall, West Street
Chichester
West Sussex
PO19 1RQ
(01243) 642105

west sussex county council

SITE/PROJECT: Bognor Regis Esplanade

TITLE: Traffic Signs and Road Markings
Sheet 1 of 2

SCALE @ A1: 1:200	CHECKED: DW	APPROVED: TRA
PROJECT NO: 70107377	DESIGNED: GW	DRAWN: GW
DATE: January 2024		REV: C02

DRAWING NO: 70107377-WSP-XX-XX-DR-LP-1200-01

© WSP UK Ltd

File name: I:\UK\WSPGROUP\COM\CENTRAL DATA\PROJECTS\70107377-WSP-XX-XX-DR-LP-1200-01_02.DWG, printed on 19 January 2024, 18:03:30, by Sundar, Raghini

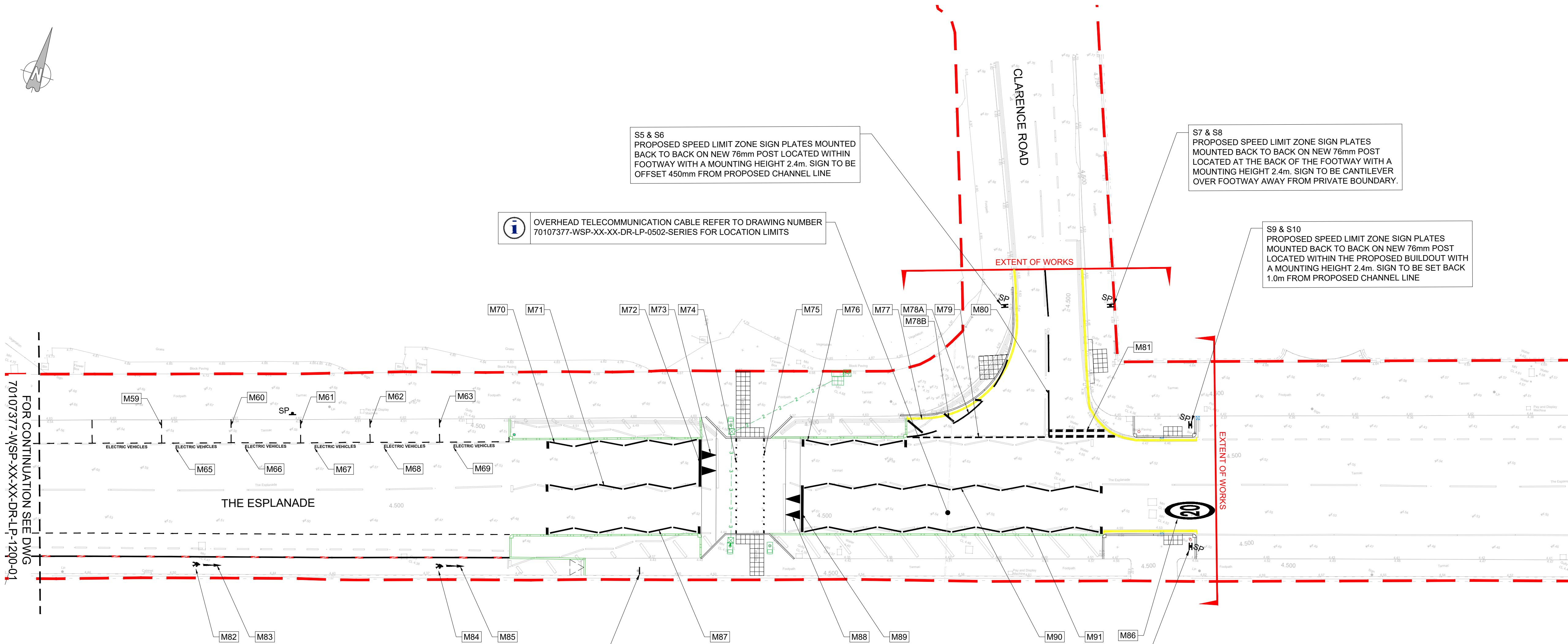

DO NOT SCALE

- NOTES:
- ALL DIMENSIONS IN METRES UNLESS OTHERWISE STATED.
 - THIS DRAWING SHOULD BE READ IN CONJUNCTION WITH ALL OTHER DETAIL DESIGN DRAWINGS AND DOCUMENTS.
 - ALL WORK TO BE IN ACCORDANCE WITH THE DESIGN MANUAL FOR ROADS AND BRIDGES (DMRB) WHERE APPROPRIATE AND WEST SUSSEX COUNTY COUNCIL DESIGN HIGHWAY STANDARD DETAILS.
 - HIGHWAY BOUNDARY HAS BEEN PROVIDED BY WSCC AND HAS BEEN ADJUSTED TO THE TOPOGRAPHICAL SURVEY FEATURES.
 - TOPOGRAPHICAL SURVEY BASED ON DRG NO. 700945-SUR-001 & 002 DATED NOVEMBER 2022 ORIGINATING FROM WSP SURVEYS.
 - CONTRACTOR TO LOCATE ALL UTILITY AND DRAINAGE ASSETS LOCATIONS ALONG WITH THE PRE-CONSTRUCTION PACK AND CO-ORDINATE SAFE WORKING PROCEDURES PRIOR TO ANY EXCAVATION WORKS TAKE PLACE.
 - THE CONTRACTOR SHALL VALIDATE THE ACCURACY OF THE TOPOGRAPHICAL SURVEY PRIOR TO ANY CONSTRUCTION WORKS BEING CARRIED OUT.
 - FOR ROAD MARKING REQUIREMENTS, REFER TO THE ROAD MARKING SCHEDULE WITHIN THIS SERIES.
 - FOR DETAILS OF PROPOSED TRAFFIC SIGNS, REFER TO SIGNING SCHEDULE WITHIN THIS SERIES FOR SIGN FACE ASSEMBLIES AND POST AND FOUNDATIONS DETAILS.
 - ALL ROAD MARKINGS SHALL BE IN ACCORDANCE WITH THE TRAFFIC SIGNS REGULATIONS AND GENERAL DIRECTIONS 2016, CHAPTER 5 OF THE TRAFFIC SIGNS MANUAL AND SUBSEQUENT AMENDMENTS.
 - ALL ROAD MARKINGS SHALL BE DEFAULT SIZE UNLESS OTHERWISE STATED, REFER TO ROAD MARKING SCHEDULE.
 - ALL PROPOSED ROAD MARKINGS SHALL TIE NEATLY INTO EXISTING ROAD MARKINGS (WHERE NECESSARY).
 - FOR ROAD MARKING REQUIREMENTS, REFER TO THE ROAD MARKING SCHEDULE WITHIN THIS SERIES.
 - THE SKID RESISTANCE VALUE OF PERMANENT ROAD MARKINGS SHALL NOT BE LESS THAN 55 PSV.
 - ALL ROAD MARKINGS ARE TO BE LAID WITH MMA 150MCD RETROREFLECTIVITY.
 - DRAINAGE GAPS OF 150mm ARE TO BE PROVIDED AT INTERVALS OF APPROXIMATELY 10m ALONG THE LENGTH OF DIAG 1012.1.
 - THE EDGE OF PROPOSED / RELOCATED SIGN FACES SHALL BE SET BACK 600mm FROM EDGE OF CARRIAGEWAY WHERE REASONABLY PRACTICAL. ABSOLUTE MINIMUM SET BACK IS 400mm.
 - FOR DETAILS OF EXISTING UTILITIES, REFER TO DRAWING NUMBER 70107377-WSP-XX-XX-DR-LP-0502-SERIES.

- KEY:
- SP PROPOSED TRAFFIC SIGN PLATE AND POST (WHERE ANNOTATED ON THE DRAWING), REFER TO SIGN SCHEDULE FOR SIGN PLATE, POST, FOUNDATION AND ASSEMBLY DETAILS.
 - SP EXISTING TRAFFIC SIGN PLATE AND POST (WHERE ANNOTATED ON THE DRAWING) WITH ASSOCIATED FOUNDATIONS TO BE REMOVED AND TIPPED FROM SITE.
 - SP EXISTING TRAFFIC SIGN PLATE AND POST (WHERE ANNOTATED ON THE DRAWING) TO BE RELOCATED.
 - PROPOSED SIGNAL POLES WITH ASSOCIATED NAL SOCKETS AND DRAWPIITS - CURRENTLY SHOWN INDICATIVELY - FULL DESIGN CARRIED OUT BY TELENT AND INSTALLATION WORKS ARE TO BE CO-ORDINATED AND BASED OF TELENT DESIGN. REFER TO TELENT DESIGN SUBMISSION FOR FULL PACKAGE OF DRAWINGS AND SPECIFICATIONS.

THE CONTRACTOR SHALL NOTIFY THE PROJECT MANAGER OF ANY AMBIGUITIES OR INCONSISTENCIES WITHIN THE DOCUMENTS (WHICH ARE PART OF THIS CONTRACT) AS SOON AS THE CONTRACTOR BECOMES AWARE

DRAWING DESIGN PACKAGE SHOWS THE PERMANENT WORK ELEMENTS / AREAS ONLY. TEMPORARY WORKING AREAS, ACCESS ROUTES, ETC. ARE TO BE DETERMINED BY CONTRACTOR. THE CONTRACTOR SHALL NOTE THE PRESENCE OF EXISTING UTILITIES AS SHOWN ON DRAWING NUMBER 70107377-WSP-XX-XX-DR-LP-502-SERIES AND CONSIDER THE UTILITY INTERFACE AND ADDITIONAL SITE CLEARANCE NECESSARY FOR ANY TEMPORARY WORKS REQUIRED.

IMPORTANT NOTE:
NO EXISTING ROAD MARKINGS TO BE REMOVED AS THE EXISTING CARRIAGEWAY IS TO BE RESURFACED AS PART OF THE SCHEME WORKS.
SURFACING WORKS TO BE CO-ORDINATED BY WSCC PRIOR TO ROAD MARKING INSTALLATION

C02	15/01/2024	RS	ROUNDELS RELOCATED BASED ON WSCC INSTRUCTION	DW	RA
C01	07/12/2023	RS	ISSUED FOR CONSTRUCTION	RA	SG
P02	29/11/2023	RS	INPRINT COLOUR CHANGE AND REMOVAL AT UNCONTROLLED CROSSING POINTS + REMOVAL OF BLUE BACKING ON PED SYMBOLS	RA	SG
P01	16/10/2023	GW	FIRST ISSUE	RA	SG
REV	DATE	BY	DESCRIPTION	CHK	APP

DRAWING STATUS: S5 - FOR CONSTRUCTION

wsp

2 London Square, Cross Lanes, Guildford, GU1 1UN, UK
T+ 44 (0) 1483 528 400
wsp.com

CLIENT:
West Sussex County Council
Highways, Transport and Planning
County Hall, West Street
Chichester
West Sussex
PO19 1RQ
(01243) 642105



SITE/PROJECT:
Bognor Regis Esplanade

TITLE:
Traffic Signs and Road Markings
Sheet 2 of 2

SCALE @ A1: 1:200	CHECKED: DW	APPROVED: TRA
PROJECT NO: 70107377	DESIGNED: GW	DRAWN: GW
	DATE: January 2024	

DRAWING NO: 70107377-WSP-XX-XX-DR-LP-1200-02	REV: C02
---	-------------

© WSP UK Ltd

HEALTH AND SAFETY SYMBOLS LEGEND:

- INDICATES A RESIDUAL RISK REQUIRING A COMPULSORY ACTION
- INDICATES A RESIDUAL RISK FOR INFORMATION
- INDICATES A RESIDUAL RISK REQUIRING A PROHIBITIVE ACTION
- INDICATES A RESIDUAL RISK AS A WARNING